

The circled numbers are the item numbers shown in the left column of the Parts list chapter on pages A10 and A11.

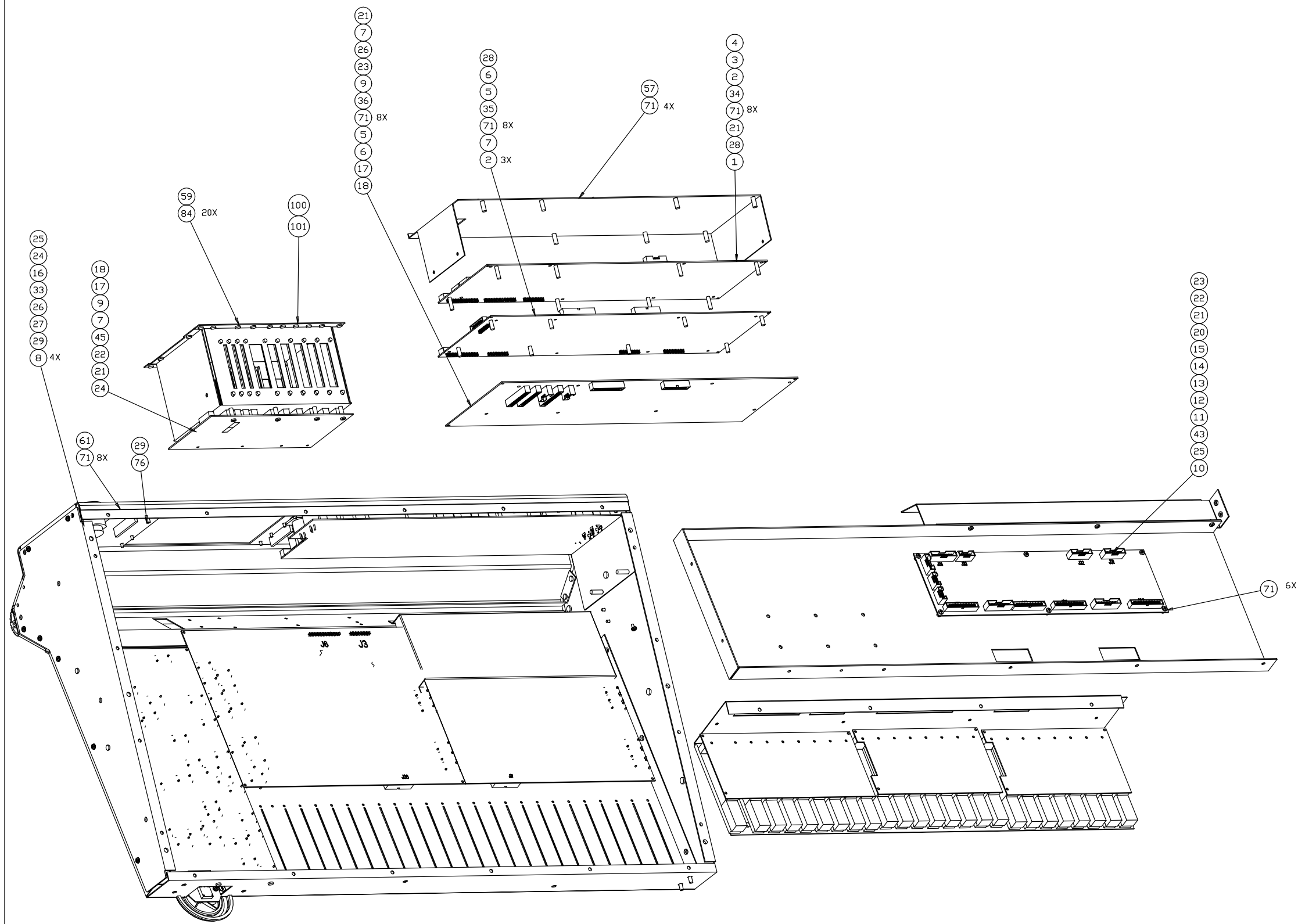

The circled numbers are the item numbers shown in the left column of the Parts list chapter on pages A10 and A11.

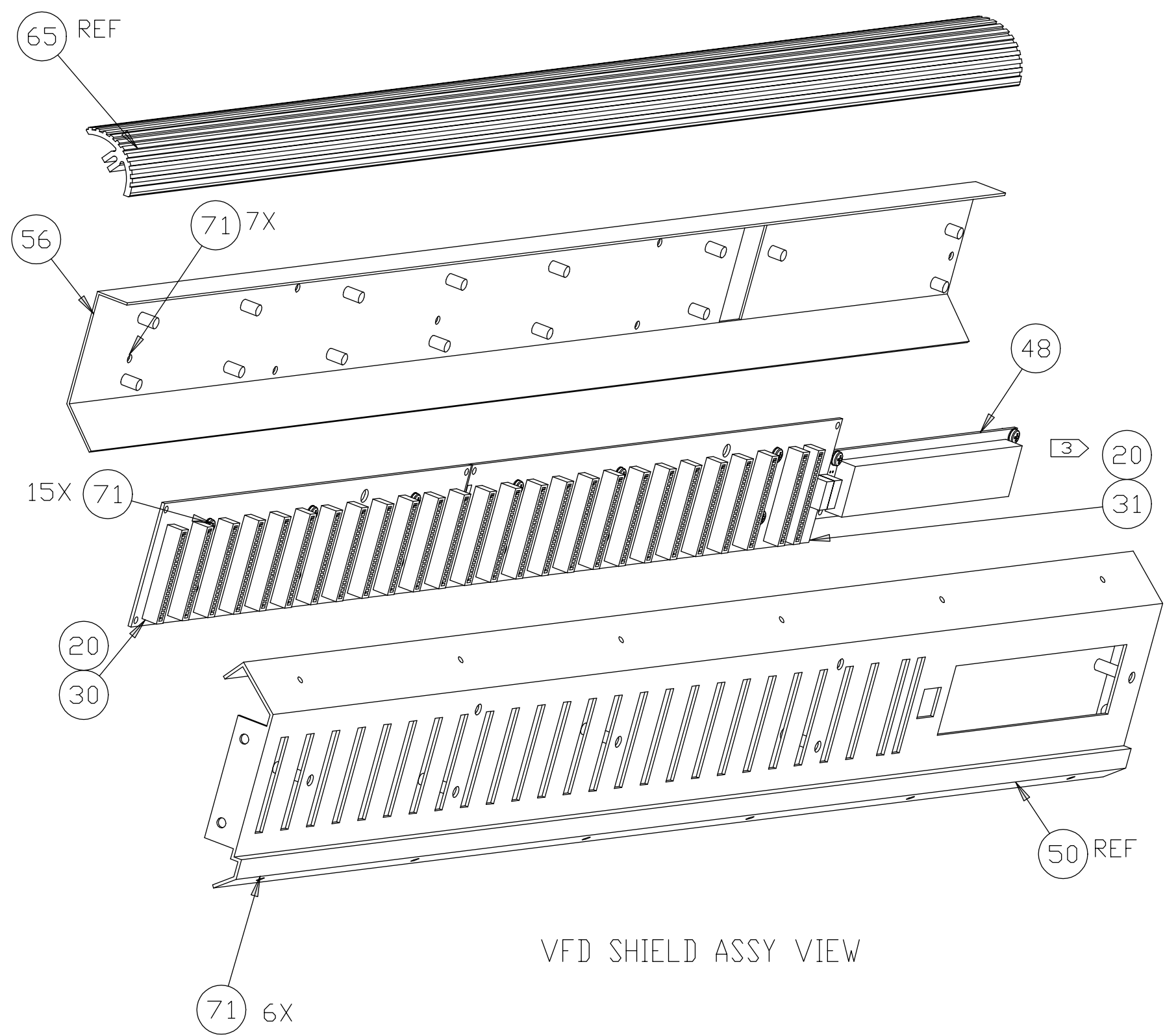

The circled numbers are the item numbers shown in the left column of the Parts list chapter on pages A10 and A11.

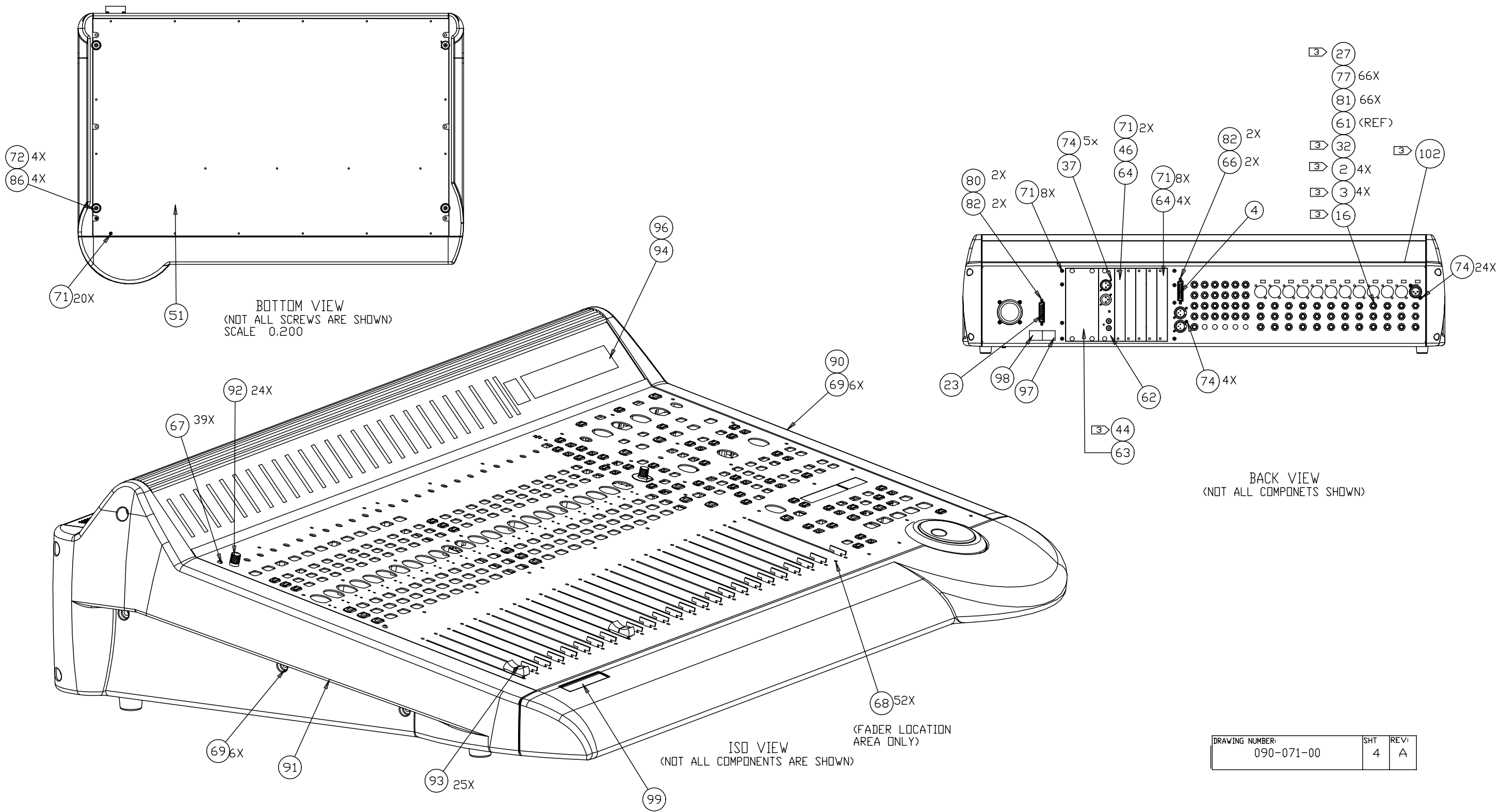

The circled numbers are the item numbers shown in the left column of the Parts list chapter on pages A10 and A11.

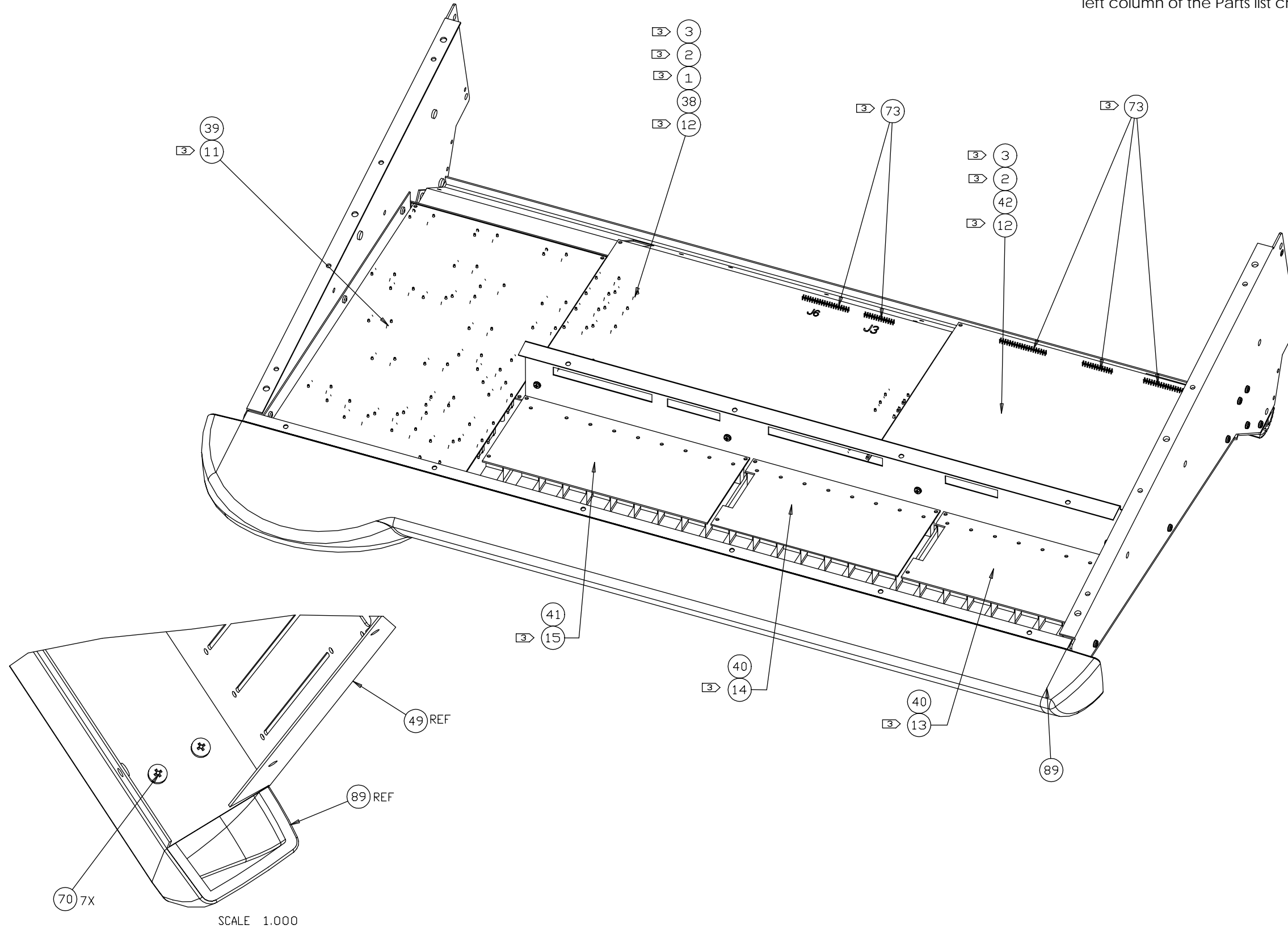

The circled numbers are the item numbers shown in the left column of the Parts list chapter on pages A12 and A13.

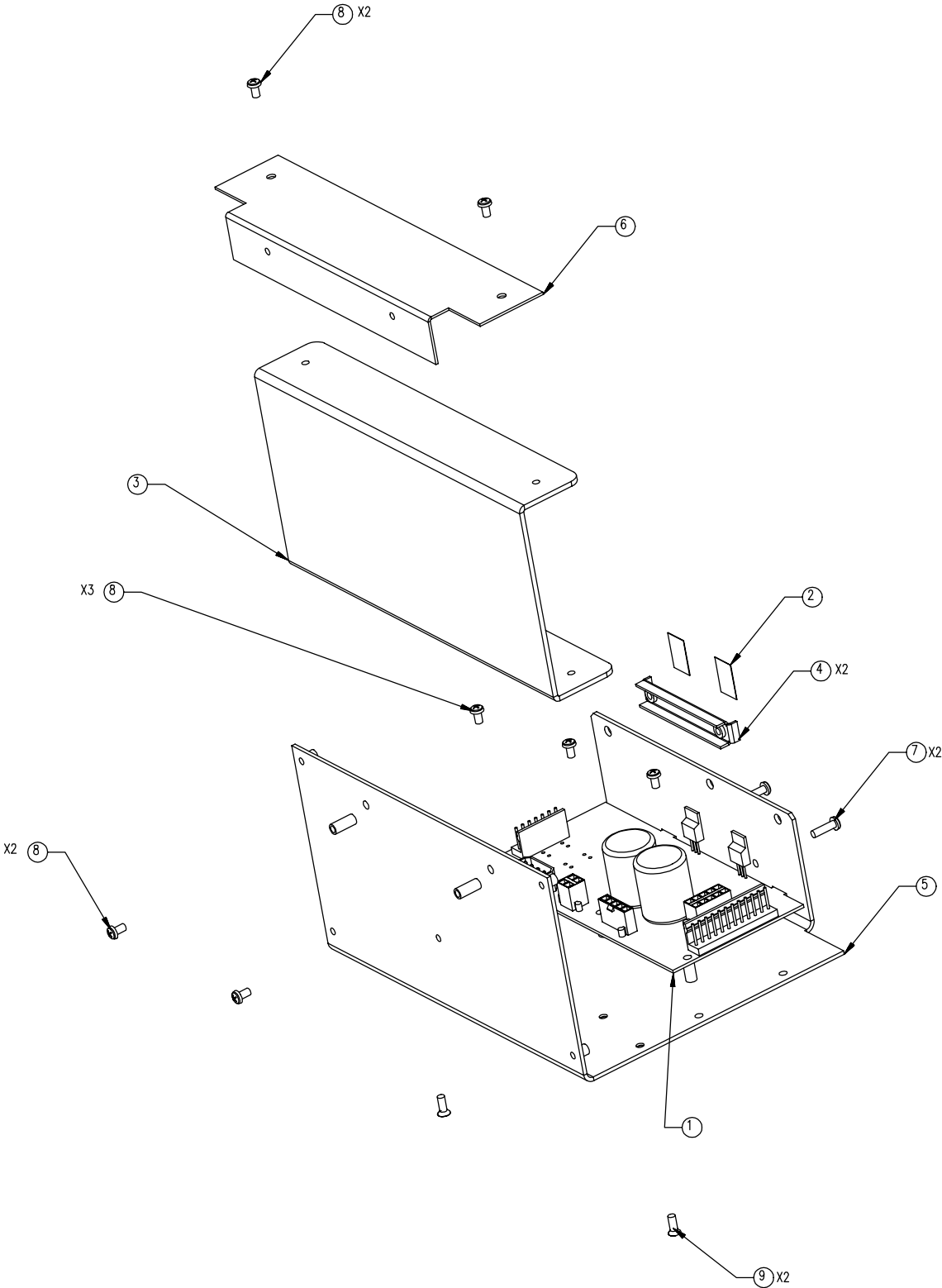

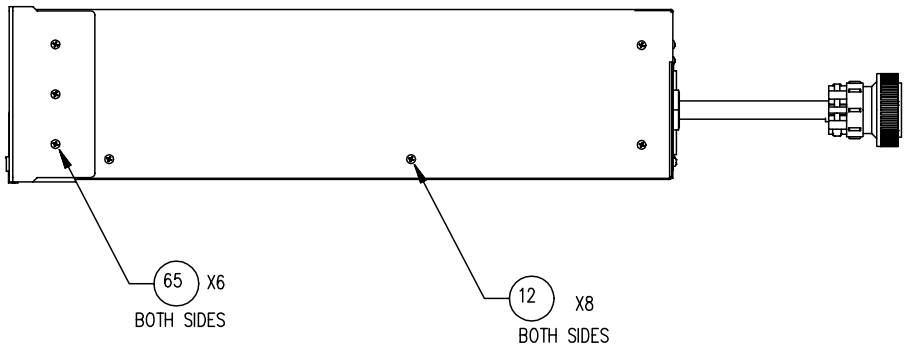
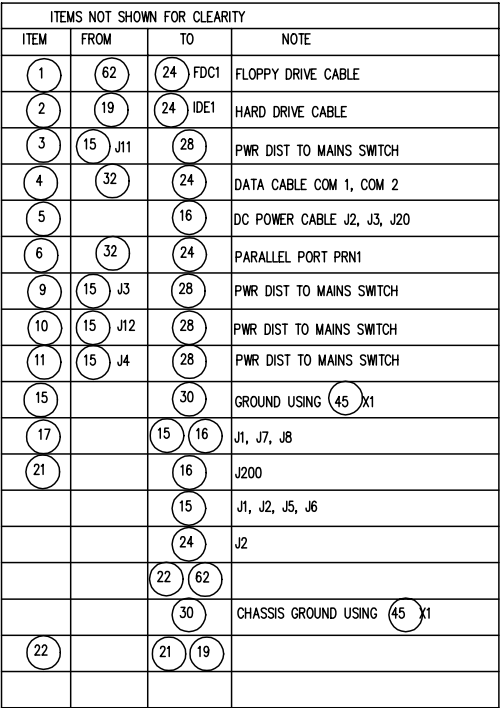

RIGHT SIDE VIEW

NOTES:

- 1 REFERENCE MANUFACT BOM
- 2 REFERENCE ASSEMBLY AID FOR INSTALLATION INFORMATION
- 3 NOT SHOWN FOR CLARITY

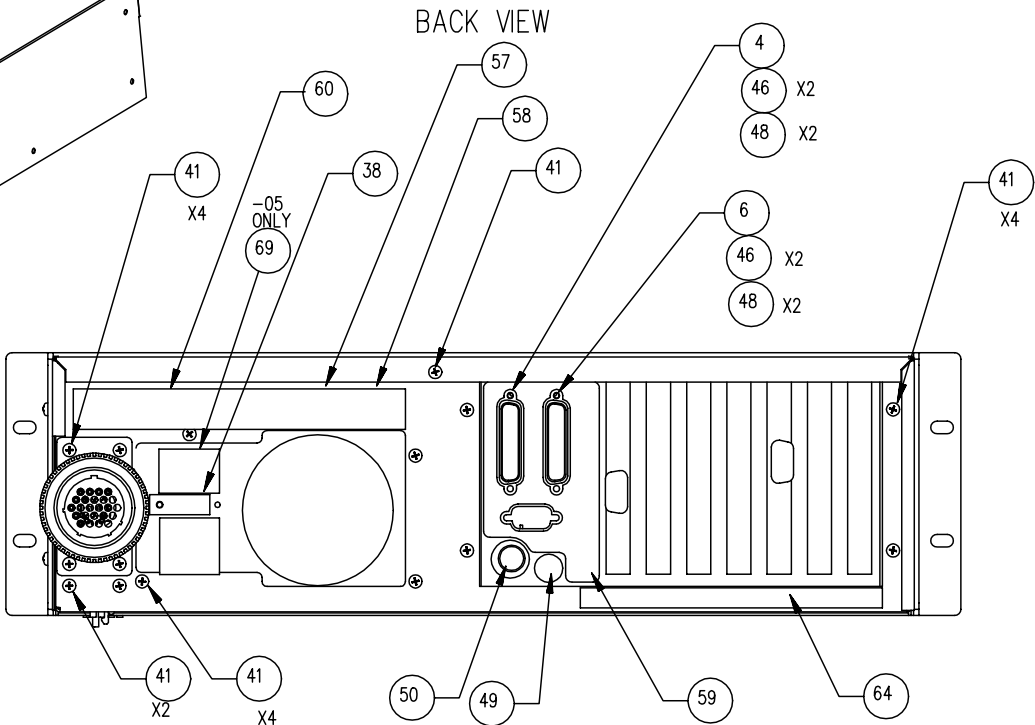
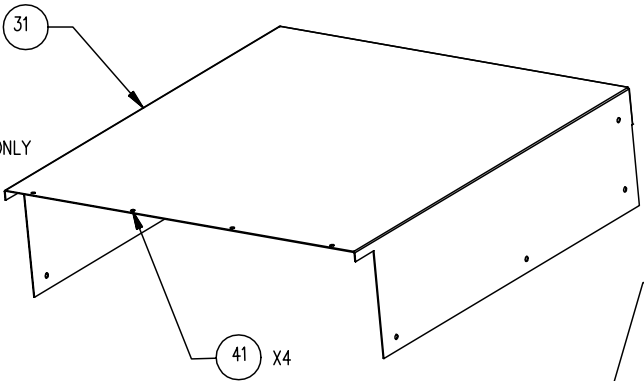

-00	120V UL
-05	230V NON-CE